

- Timber framing that complies with the NZ building code or for existing has the equivalent stiffness to the framing provisions of NZS 3604:2011
- Flexible or rigid underlay to comply with Table 23 (E2/AS1 or E2/AS4), or have an applicable CodeMark or BRANZ appraisal. Underlay to be installed in accordance with the underlay product supplier's requirements.
- Hume Pine Board & Batten Weatherboards to be fixed in accordance with HPDBBV-C1

## Hume Pine Board & Batten Weatherboard Fixing to Timber Frame

Version V2.1  
Scale 1:2.5  
Date: 12/1/2023  
Ref: HPDBBV-C3

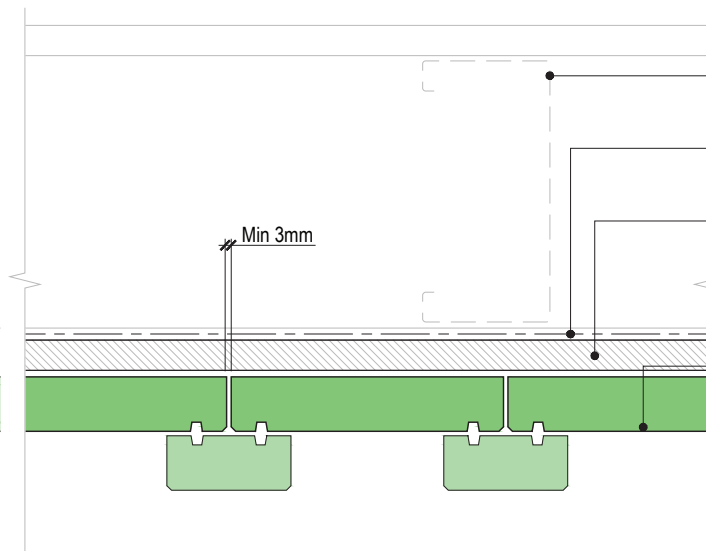

- Lightweight steel framing that complies with the NZ building code or for existing has the equivalent stiffness to the framing provisions of NZS 3604:2011.
- Flexible or rigid underlay to comply with table 23 (E2/AS1 or E2/AS4), or have an applicable CodeMark or BRANZ appraisal.
- A thermal break is required. Underlay and thermal break to be installed in accordance with the underlay or thermal break product supplier's requirements.
- Hume Pine Board & Batten Weatherboards to be fixed in accordance with HPDBBV-C2

## Hume Pine Board & Batten Weatherboard Fixing to Lightweight Steel

Version V2.1  
Scale 1:2.5  
Date: 12/1/2023  
Ref: HPDBBV-C4



CodeMark  
CMNZ30106

